

HONDA

CORDLESS CHAIN SAW

HHC36YXB D16

Owner's Manual

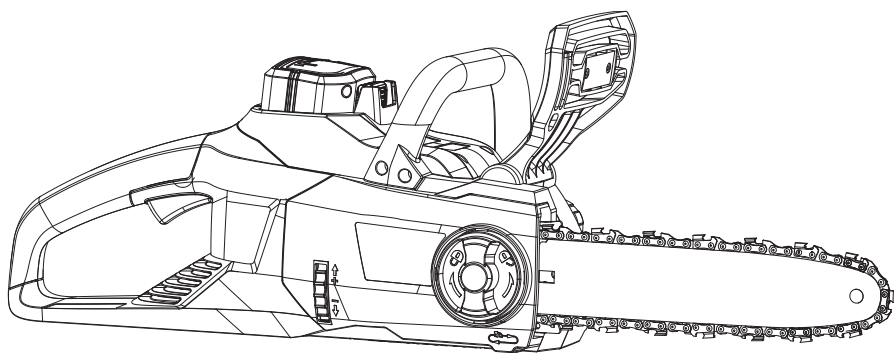

ORIGINAL INSTRUCTIONS

Thank you for choosing Honda Chain Saw. For your safe use, please read this manual before operating and save the manual properly.

PREFACE

Thank you for purchasing a Honda Chain Saw.

Keep this Owner's Manual handy, so you can refer to it at any time. This manual should be considered a permanent part of this product and should remain with the this product if it is resold.

No part of this publication may be reproduced without written permission.

We want to help you get the best results from your new product and to operate it safely.

This manual contains all the information on how to do that, please read it carefully.

As you read this manual you will find information preceded by a NOTE/WARNING symbol. This information is intended to help you avoid injury to you or others and damage to your product, other property, or the environment.

The products shown in this manual may differ from the actual products.

If a problem should arise, or if you have any questions about your product, consult your servicing dealer. Honda dealer is dedicated to your satisfaction and will be pleased to answer your questions and concerns.

Honda Motor Co., Ltd.

CONTENTS

Product Instruction.....	1
Warning Label.....	2
Safety Instructions.....	3
Main Specification.....	7
Product Assembly.....	8
Bar and Chain Oil Filling.....	10
Charging the Battery Pack.....	11
Operation.....	13
Daily Maintenance.....	16
Troubleshooting.....	17
Technical Information.....	18

PRODUCT INTRODUCTION

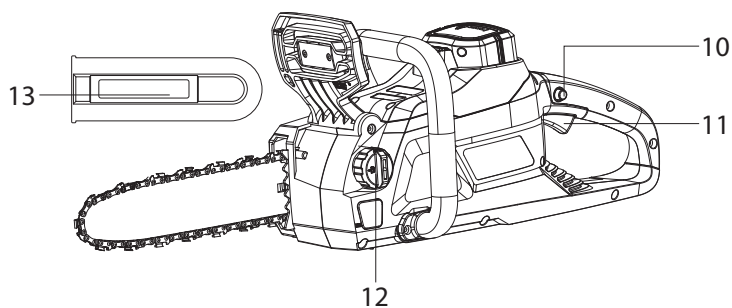
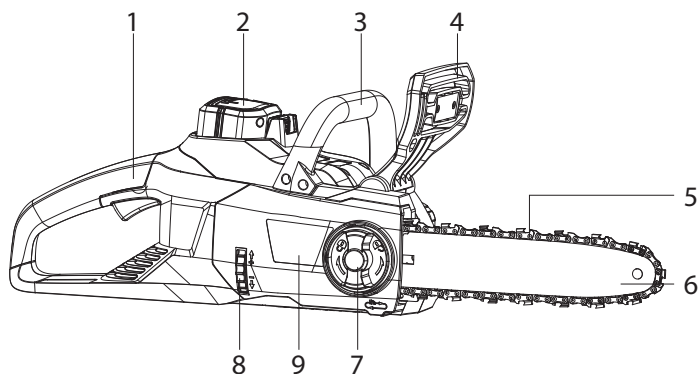

- | | |
|--------------------------------|--------------------------|
| 1. Rear Handle | 8. Chain Adjustment Knob |
| 2. Battery Pack | 9. Side Cover |
| 3. Front Handle | 10. Lock-off Button |
| 4. Chain Kickback Brake Handle | 11. Switch Trigger |
| 5. Saw Chain | 12. Oil-tank Cap |
| 6. Guide Bar | 13. Guide bar cover |
| 7. Side Cover Knob | |

WARNING LABEL

Warning labels will remind you of potential hazards that may cause harm, please read carefully. If the label falls off or the content is unclear, please contact your servicing dealer.

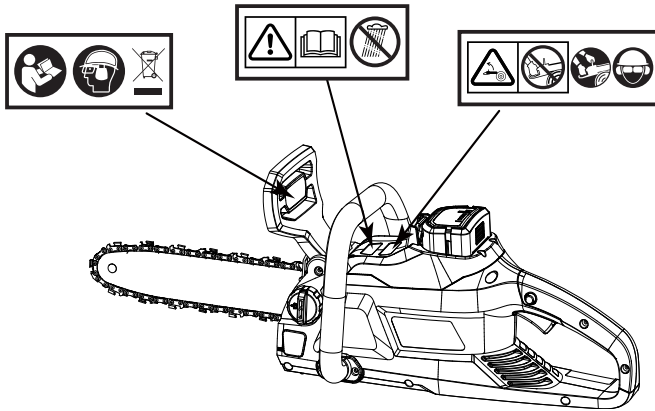

Warning!



Read the operator's manual.



WARNING - To reduce the risk of injury, user must read instruction manual.



Do not expose the product to rain or wet conditions.



Beware of chain saw kickback and avoid contact with bar tip.



Do not use chain saw one-handed.



Always use the product with two hands.



Wear head/eye/ear protection.



Wear head/eye/ear protection.



Power tools that are no longer usable and defective or used battery packs/batteries, must be collected separately and disposed of in an environmentally correct manner.

SAFETY INSTRUCTIONS

GENERAL POWER TOOL SAFETY WARNINGS



Read all safety warnings, instructions, illustrations and specifications, provided with this power tool. *Failure to follow all instructions listed below may result in electric shock, fire and/or serious injury.*

Save all warnings and instructions for future reference.

The term "power tool" in the warnings refers to your mains-operated (corded) power tool or battery-operated (cordless) power tool.

1) Work Area Safety

- a. **Keep work area clean and well lit.** *Cluttered or dark areas invite accidents.*
- b. **Do not operate power tools in explosive atmospheres, such as in the presence of flammable liquids, gases or dust.** *Power tools create sparks which may ignite the dust or fumes.*
- c. **Keep children and bystanders away while operating a power tool.** *Distractions can cause you to lose control.*

2) Electrical Safety

- a. **Power tool plugs must match the outlet. Never modify the plug in any way. Do not use any adapter plugs with earthed (grounded) power tools.** *Unmodified plugs and matching outlets will reduce risk of electric shock.*
- b. **Avoid body contact with earthed or grounded surfaces, such as pipes, radiators, ranges and refrigerators.** *There is an increased risk of electric shock if your body is earthed or grounded.*
- c. **Do not expose power tools to rain or wet conditions.** *Water entering a power tool will increase the risk of electric shock.*
- d. **Do not abuse the cord. Never use the cord for carrying, pulling or unplugging the power tool. Keep cord away from heat, oil, sharp edges or moving parts.** *Damaged or entangled cords increase the risk of electric shock.*
- e. **When operating a power tool outdoors, use an extension cord suitable for outdoor use.** *Use of a cord suitable for outdoor use reduces the risk of electric shock.*
- f. **If operating a power tool in a damp location is unavoidable, use a residual current device (RCD) protected supply.** *Use of an RCD reduces the risk of electric shock.*

3) Personal Safety

- a. **Stay alert, watch what you are doing and use common sense when operating a power tool. Do not use a power tool while you are tired or under the influence of drugs, alcohol or medication.** *A moment of inattention while operating power tools may result in serious personal injury.*
- b. **Use personal protective equipment. Always wear eye protection.** *Protective equipment such as a dust mask, non-skid safety shoes, hard hat or hearing protection used for appropriate conditions will reduce personal injuries.*
- c. **Prevent unintentional starting. Ensure the switch is in the off-position before connecting to power source and/or battery pack, picking up or carrying the tool.** *Carrying power tools with your finger on the switch or energising power tools that have the switch on invites accidents.*
- d. **Remove any adjusting key or wrench before turning the power tool on.** *A wrench or a key left attached to a rotating part of the power tool may result in personal injury.*
- e. **Do not overreach. Keep proper footing and balance at all times.** *This enables better control of the power tool in unexpected situations.*
- f. **Dress properly. Do not wear loose clothing or jewellery. Keep your hair and clothing away from moving parts.** *Loose clothes, jewellery or long hair can be caught in moving parts.*

SAFETY INSTRUCTIONS

- g. **If devices are provided for the connection of dust extraction and collection facilities, ensure these are connected and properly used.** *Use of dust collection can reduce dust-related hazards.*
- h. **Do not let familiarity gained from frequent use of tools allow you to become complacent and ignore tool safety principles.** *A careless action can cause severe injury within a fraction of a second.*

4) Power Tool Use And Care

- a. **Do not force the power tool. Use the correct power tool for your application.** *The correct power tool will do the job better and safer at the rate for which it was designed.*
- b. **Do not use the power tool if the switch does not turn it on and off.** *Any power tool that cannot be controlled with the switch is dangerous and must be repaired.*
- c. **Disconnect the plug from the power source and/or remove the battery pack, if detachable, from the power tool before making any adjustments, changing accessories, or storing power tools.** *Such preventive safety measures reduce the risk of starting the power tool accidentally.*
- d. **Store idle power tools out of the reach of children and do not allow persons unfamiliar with the power tool or these instructions to operate the power tool.** *Power tools are dangerous in the hands of untrained users.*
- e. **Maintain power tools and accessories. Check for misalignment or binding of moving parts, breakage of parts and any other condition that may affect the power tool's operation. If damaged, have the power tool repaired before use.** *Many accidents are caused by poorly maintained power tools.*
- f. **Keep cutting tools sharp and clean.** *Properly maintained cutting tools with sharp cutting edges are less likely to bind and are easier to control.*
- g. **Use the power tool, accessories and tool bits etc. in accordance with these instructions, taking into account the working conditions and the work to be performed.** *Use of the power tool for operations different from those intended could result in a hazardous situation.*
- h. **Keep handles and grasping surfaces dry, clean and free from oil and grease.** *Slippery handles and grasping surfaces do not allow for safe handling and control of the tool in unexpected situations.*

5) Battery Tool Use And Care

- a. **Recharge only with the charger specified by the manufacturer.** *A charger that is suitable for one type of battery pack may create a risk of fire when used with another battery pack.*
- b. **Use power tools only with specifically designated battery packs.** *Use of any other battery packs may create a risk of injury and fire.*
- c. **When battery pack is not in use, keep it away from other metal objects, like paper clips, coins, keys, nails, screws or other small metal objects, that can make a connection from one terminal to another.** *Shorting the battery terminals together may cause burns or a fire.*
- d. **Under abusive conditions, liquid may be ejected from the battery; avoid contact. If contact accidentally occurs, flush with water. If liquid contacts eyes, additionally seek medical help.** *Liquid ejected from the battery may cause irritation or burns.*
- e. **Do not use a battery pack or tool that is damaged or modified.** *Damaged or modified batteries may exhibit unpredictable behaviour resulting in fire, explosion or risk of injury.*
- f. **Do not expose a battery pack or tool to fire or excessive temperature.** *Exposure to fire or temperature above 130°C may cause explosion.*
- g. **Follow all charging instructions and do not charge the battery pack or tool outside the temperature range specified in the instructions.** *Charging improperly or at temperatures outside the specified range may damage the battery and increase the risk of fire.*

6) Service

- a. **Have your power tool serviced by a qualified repair person using only identical replacement parts.** *This will ensure that the safety of the power tool is maintained.*
- b. **Never service damaged battery packs.** *Service of battery packs should only be performed by the*

SAFETY INSTRUCTIONS

manufacturer or authorized service providers.

SAFETY INSTRUCTIONS FOR CHAIN SAWS

- a. **Keep all parts of the body away from the saw chain when the chain saw is operating. Before you start the chain saw, make sure the saw chain is not contacting anything.** *A moment of inattention while operating chain saws may cause entanglement of your clothing or body with the saw chain.*
- b. **Always hold the chain saw with your right hand on the rear handle and your left hand on the front handle.** *Holding the chain saw with a reversed hand configuration increases the risk of personal injury and should never be done.*
- c. **Hold the chain saw by insulated gripping surfaces only, because the saw chain may contact hidden wiring.** *Saw chains contacting a "live" wire may make exposed metal parts of the chain saw "live" and could give the operator an electric shock.*
- d. **Wear eye protection. Further protective equipment for hearing, head, hands, legs and feet is recommended.** *Adequate protective equipment will reduce personal injury from flying debris or accidental contact with the saw chain.*
- e. **Do not operate a chain saw in a tree, on a ladder, from a rooftop, or any unstable support.** *Operation of a chain saw in this manner could result in serious personal injury.*
- f. **Always keep proper footing and operate the chain saw only when standing on fixed, secure and level surface.** *Slippery or unstable surfaces such as ladders may cause a loss of balance or control of the chain saw.*
- g. **When cutting a limb that is under tension be alert for spring back.** *When the tension in the wood fibres is released the spring loaded limb may strike the operator and/or throw the chain saw out of control.*
- h. **Use extreme caution when cutting brush and saplings.** *The slender material may catch the saw chain and be whipped toward you or pull you off balance.*
- i. **Carry the chain saw by the front handle with the chain saw switched off and away from your body. When transporting or storing the chain saw always fit the guide bar cover.** *Proper handling of the chain saw will reduce the likelihood of accidental contact with the moving saw chain.*
- j. **Follow instructions for lubricating, chain tensioning and changing the bar and chain.** *Improperly tensioned or lubricated chain may either break or increase the chance for kickback.*
- k. **Cut wood only. Do not use chain saw for purposes not intended. For example: do not use chain saw for cutting metal, plastic, masonry or non-wood building materials.** *Use of the chain saw for operations different than intended could result in a hazardous situation.*
- l. **Do not attempt to fell a tree until you have an understanding of the risks and how to avoid them.** *Serious injury could occur to the operator or bystanders while felling a tree.*

GENERAL CHAIN SAW SAFETY WARNINGS

- a. **Follow all instructions when clearing jammed material, storing or servicing the chain saw. Make sure the switch is off and the battery pack is removed.** *Unexpected actuation of the chain saw while clearing jammed material or servicing may result in serious personal injury.*

CAUSES AND OPERATOR PREVENTION OF KICKBACK

Kickback may occur when the nose or tip of the guide bar touches an object, or when the wood closes in and pinches the saw chain in the cut.

Tip contact in some cases may cause a sudden reverse reaction, kicking the guide bar up and back towards the operator.

Pinching the saw chain along the top of the guide bar may push the guide bar rapidly back towards the

SAFETY INSTRUCTIONS

operator.

Either of these reactions may cause you to lose control of the saw which could result in serious personal injury. Do not rely exclusively upon the safety devices built into your saw.

As a chain saw user, you should take several steps to keep your cutting jobs free from accident or injury. Kickback is the result of chain saw misuse and/or incorrect operating procedures or conditions and can be avoided by taking proper precautions as given below:

- **Maintain a firm grip, with thumbs and fingers encircling the chain saw handles, with both hands on the saw and position your body and arm to allow you to resist kickback forces. Kickback forces can be controlled by the operator, if proper precautions are taken.** *Do not let go of the chain saw.*
- **Do not overreach and do not cut above shoulder height.** *This helps prevent unintended tip contact and enables better control of the chain saw in unexpected situations.*
- **Only use replacement bars and chains specified by the manufacturer.** *Incorrect replacement bars and chains may cause chain breakage and/or kickback.*
- **Follow the manufacturer's sharpening and maintenance instructions for the saw chain.** *Decreasing the depth gauge height can lead to increased kickback.*

MAIN SPECIFICATION

Model	HHC36YXB D16
Rated Voltage	36V DC
Rated Power	600 W
Chain Speed	13.5 m/s
Max. Cutting Length	406 mm
Oil Tank	120 ml
Guide Bar Length	455 mm
Saw Chain Type	Type/Model NO. : 3/8LP.050.56E 91NP
Guide Bar Type	Type/Model NO. : ES160SDEA041
Operating Type	two-handed
Overall Size	(796~819)×214×198 mm
Weight (Tool Only)	3.4 kg

Applicable Battery Pack	DP3650XYD
Applicable Charger	CV3660XY
Recommended Charge Temperature	0°C - 40°C
Recommended Discharge Temperature	-17°C - 70°C

Charger Model	Type	Sales Destination	Plug Type
CV3660XY	DC	D: General Area	C Type
	DO2	D: General Area	O2 Type
	DB3	D: General Area	B3 Type
	DA	D: General Area	A Type
	NM	N: South Africa	M Type
	LG	L: Middle East	G Type

PRODUCT ASSEMBLY

INSTALLING THE SAW CHAIN AND GUIDE BAR



WARNING!

It's recommended to wear protective gloves when performing the installation for avoiding personal injuries.

1. Turn the side cover knob counterclockwise to remove the side cover and then turn the chain adjustment knob down to loose the chain as much as possible.



WARNING!

If the machine has been used, please clean the residual wood chips and debris on the side cover in time to ensure assembly accuracy of the next step: installing the guide bar and chain.

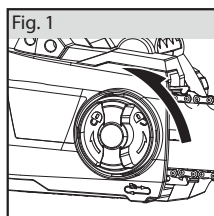

2. Lay the saw chain in a loop on a flat surface and straighten any kinks.
3. Place the saw chain into the guide bar groove and make the chain a loop at the back of the guide bar. Make sure the saw chain is in correct running direction by comparing saw chain with the rotation symbol shown in Fig. 2.
4. After installing the chain on the guide bar, place the guide bar with chain installed vertically to make sure one end of the guide bar is on the top, and use gloved hand to pull the chain around to check whether the sliding is smooth.

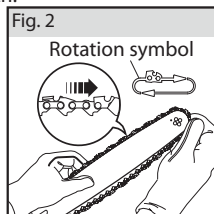

WARNING!

It's recommended to check the guide bar and chain as described above before each use. If the sliding is not smooth, it may be necessary to replace or repair the guide bar and chain.

5. Hold the chain in position on the guide bar and place the loop around the sprocket.
6. Slide the guide bar slot over the alignment flanges until the tension adjusting pin is inserted in the hole in the tail of the bar.

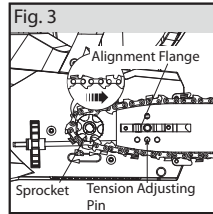

- Put on the side cover and slightly turn the chain adjustment knob up to tighten the saw chain and guide bar. And then replace the side cover and slightly tighten the side cover knob.

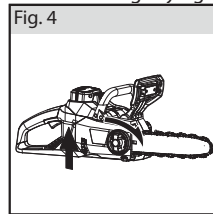

- Lift the tip of the guide bar up to check for sag. Release the tip of the guide bar and turn the chain adjustment knob up. Repeat this process until the sag is eliminated.
- Tighten the side cover knob securely to ensure that the saw chain is properly tensioned before using.



WARNING!

To extend the guide bar life, invert the guide bar occasionally.

ADJUSTING THE CHAIN TENSION

Stop the motor and disconnect the product from power supply before adjusting the chain tension. Make sure the side cover knob is loosened. Turn the chain adjustment knob up till the chain comes to a suitable status. Tighten the side cover knob after adjustment. See the section: "INSTALLING THE SAW CHAIN AND THE GUIDE BAR" for more detailed information.

During normal saw operation, the temperature of the chain will increase. A properly tensioned chain should have no sag. And the drive links of a correctly tensioned chain should be able to be pulled approximately 2~4 mm out of the bar groove.

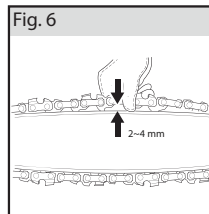
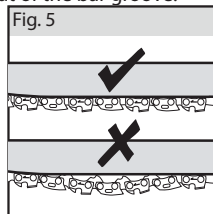

INSTALLING THE BATTERY PACK

Align the grooves in the battery pack with the raised ribs in the battery compartment and then insert the battery pack into the compartment until you hear a "click".

PRODUCT ASSEMBLY

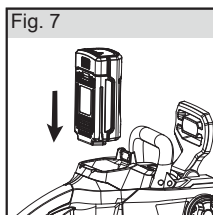

BAR AND CHAIN OIL FILLING



WARNING!

Use a filter when filling the oil tank with bar and chain oil, as this will reduce the risk of the product's performance being affected by residue in the lubricant. To avoid oil leakage, it's recommended that the maximum oil level is 3 mm below the opening of the oil tank. The product should not be tilted to the left at an angle of more than 15° after the oil has been filled.



WARNING!

Do not use waste oil as it may cause damage to the oil pump, guide bar and saw chain. Damage to the chain may cause serious personal injury.

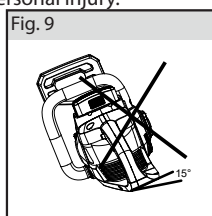
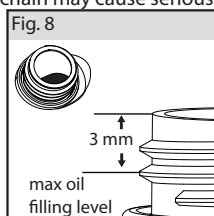

1. Position the chain saw on its side on a firm, flat surface, so that the tank cap is facing upwards.
2. Clean the oil tank cap and the area around it to ensure that no dirt falls into the oil tank. Rotate the oil tank cap counterclockwise to remove it.
3. Carefully pour the bar and chain oil into the tank. If the product has not been used for a long time, drain out all the remaining oil before filling new one. Please use special containers to hold the draining oil hand it over to an authorized institution for recycling and disposal.
4. Replace the oil tank cap and tighten it clockwise. Wipe the remaining oil around the tank with a clean cloth.

Bar and chain oil: 32 # anti-wear hydraulic oil

CHARGING THE BATTERY PACK

HOW TO CHARGE THE BATTERY PACK

1. Charge the Lithium-Ion battery pack only with the correct charger.
2. Connect the charger to a power supply. The LED indicator on the charger will turn red.
3. Align the raised ribs of the battery pack with the slot in the charger.
4. Insert the battery pack into the charger. The LED indicator on the charger will turn green and begin to flash.
5. The charger will communicate with the battery pack to evaluate the condition of the battery pack.
6. The battery pack is fully charged when all four of its LEDs are fully lit. Disconnect the power supply from the charger. Remove the battery pack from the charger.

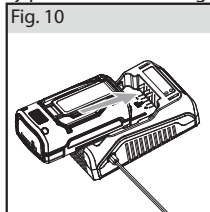

Lights	Light indicators	Status
One red light on		Power on
One green light flashing		Normal charging
One green light on		Charge over
One red light flashes at a frequency of 1Hz		Abnormal voltage of battery
Red light and green light flash alternately at a frequency of 1 Hz		Abnormal temperature of battery

CHARGING INDICATOR

Press the capacity indicator button on the battery pack to check current charge level before installing the battery pack, and the indicator will light up.

CHARGING THE BATTERY PACK

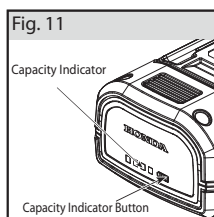

Indicators		Status
Fully Lit	Off	
■	□	
■ ■ ■ ■		75% - 100%
■ ■ ■ □		50% - 75%
■ ■ □ □		25% - 50%
■ □ □ □		5% - 25%
□ □ □ □		Needs to be charged

If more than one indicators are on, the battery pack can be charged according to the real situation. If none of the indicators are on, the battery pack must be fully charged before use.



NOTE!

To prolong battery life, store the battery pack separately from the tool in a 50% charged condition.



WARNING!

Charge the battery pack in the temperature of between 0°C and 40°C.

OPERATION

1. Check the position of the kickback brack handle to make sure it's engaged in the operation position. If not, pull it towards the front handle.
2. Use both hands to grasp the front and rear handles firmly.
3. Press and hold the lock-off button with the thumb of your right hand, and then squeeze the switch trigger with other fingers of your right hand to start the chain saw.
4. Release the lock-off button and continue to squeeze the trigger for continued operation.
5. To stop the product, release the trigger. Push the kickback brake handle forward to the brake position.



WARNING!

If you first hold the switch trigger and then pull the kickback brack back to turn on the chain saw, the product will not start. The product will only start when the kickback brack is reset and both the lock-off button and switch trigger are pressed at the same time.

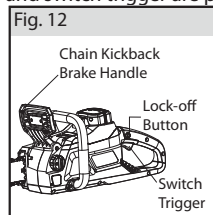

WARNING!

Do not insert or remove the battery when the trigger is pressed or operating the chain saw.

6. This chain saw has a overload protection function. During the cutting process, the chain saw may have a sudden stop due to excessive force or encountering hard subjects. In this case, squeeze the switch trigger again to restart the chain saw.
7. To avoid oil leakage, oil tank cap should not face vertically downwards during operation.

INSTRUCTIONS CONCERNING THE PROPER TECHNIQUES



WARNING!

Never start the chain saw when it is in contact with the wood. Always allow the chain saw reach full speed before applying the saw to the wood. It is recommended that the first-time user should, as a minimum, practise cutting logs on a saw-horse or cradle.

Felling a tree

1. When bucking and felling operations are being performed by two or more persons at the same time, the felling operations should be separated from the bucking operation by a distance of at least twice the height of the tree being felled. Trees should not be felled in a manner that would endanger any person, strike any utility line or cause any property damage. If the tree does make contact with any utility line, the company should be notified immediately.
2. The product operator should keep on the uphill side of the terrain as the tree is likely to roll or slide downhill after it is felled.
3. An escape path should be planned and cleared as necessary before cuts are started. The escape path should extend back and diagonally to the rear of the expected line of fall.

OPERATION

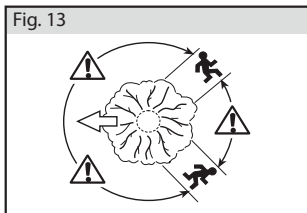

4. Before felling is started, consider the natural lean of the tree, the location of larger branches and the wind direction to judge which way the tree will fall.
5. Remove dirt, stones, loose bark, nails, staples and wire from the tree.

Notching undercut and felling back cut

Make the notch (B) 1/3 the diameter of the tree, perpendicular to the direction of falls. Make the lower horizontal notching cut first. This will help to avoid pinching either the saw chain or the guide bar when the second notch is being made.

Make the felling back cut (A) at least 50 mm higher than the horizontal notching cut. Keep the felling back cut parallel to the horizontal notching cut. Make the felling back cut so enough wood is left to act as a hinge. The hinge (C) wood keeps the tree from twisting and falling in the wrong direction. Do not cut through the hinge.

As the felling gets close to the hinge, the tree should begin to fall. If there is any chance that the tree may not fall in desired direction or it may rock back and bind the saw chain, stop cutting before the felling back cut is complete and use wedges of wood, plastic or aluminum to open the cut and drop the tree along the desired line of fall.

When the tree begins to fall remove the product from the cut, switch off and put the product down then use the retreat path planned. Be alert for overhead limbs falling and watch your footing.

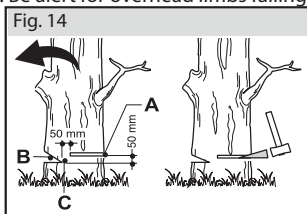

Limbing a tree

Limbing is removing the branches from a fallen tree. When limbing leave larger lower limbs to support the log off the ground. Remove the small limbs in one cut. Branches under tension should be cut from the bottom up to avoid binding the chain saw.

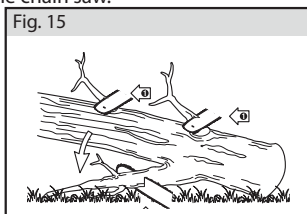

Bucking a log

OPERATION

1. Follow the simple directions for easy cutting. When the log is supported along its entire length, it is cut from the top (overbuck).

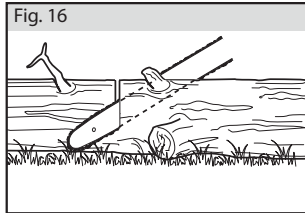

2. When the log is supported on one end, cut $\frac{1}{3}$ the diameter from the underside (underbuck). Then make the finished cut by overbucking to meet the first cut.

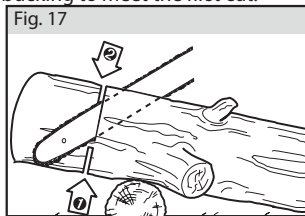

3. When the log is supported on both ends, cut $\frac{1}{3}$ the diameter from the top (overbuck). Then make the finished cut by underbucking the lower $\frac{2}{3}$ to meet the first cut.

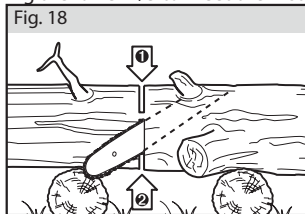

4. When bucking on a slope always stand on the uphill side of the log. When "cutting through", to maintain complete control release the cutting pressure near the end of the cut without relaxing your grip on the product handles. Do not let the chain contact the ground. After completing the cut, wait for the saw chain to stop before you move the product. Always switch off the product before moving from tree to tree.

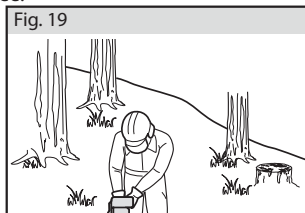

DAILY MAINTENANCE



WARNING!

Remove and pull out the battery pack before maintenance! Maintain this product regularly and carefully! If the product is improperly maintained, it may fail at its intended task, which may produce fatal consequences.

The following suggestions help increase the safety of using this product and extend its service life:

- Confirm whether the battery, charger plug and power cord are damaged or not.
- Do not allow foreign materials to cover the motor vent.
- If you find a significant decrease in the power of the product, please contact your servicing dealer to repair the product.
- Make sure the oil in the tank is sufficient, oil is delivered as normal, kickback brake system can operate effectively and chain is sharp before operating.
- Before and after every use, it is necessary to check whether the screws and nuts of each part is securely fastened, or the parts are loose, deformed, worn, or damaged. If any, please replace them immediately.
- Keep the product clean after use.
- Regularly check the chain's sharpness. It's recommended that the chain should be replaced or polished by technician.
- Regularly lubricate the chain to ensure optimal performance.
- If no use for a short period, please store the product horizontally to prevent oil leakage and install guide bar cover to reduce the risk of accidental injury.
- Store the charger and the battery pack at normal room temperature. The storage temperature is between 0°C and 45°C. Do not store it in excessive heat and do not store the battery pack on the tool.



Note:

Do not adjust the product while it is running.

Note:

The main power supply must be cut off and the product must be stopped for cooling before cleaning and daily maintenance.

Note:

Please contact your servicing dealer to repair this product and use the genuine Honda accessories.

TROUBLESHOOTING

Problem	Possible cause	Solution
Motor doesn't run	Battery pack not fully inserted	Attach properly
	Battery is discharged	Charge the battery pack
Unsatisfactory efficiency	Dull / worn chain	Replace with new one or sharpen by technician
	Over-tightened chain	Refer to the manual to tension the saw chain properly
	Poor air ventilation	Clean the air vent
Abnormal vibration	Loosen parts	Turn off the product to have a check
	Damaged system	Contact your servicing dealer for repair

TECHNICAL INFORMATION

Please write down the battery pack and the product serial number and also the purchasing date. This information is required when ordering parts and/or consulting technical or warranty information.

Battery Pack Serial Number: _____

Product Serial Number: _____

Purchasing date: _____

Product Serial Number
UAMY-*****

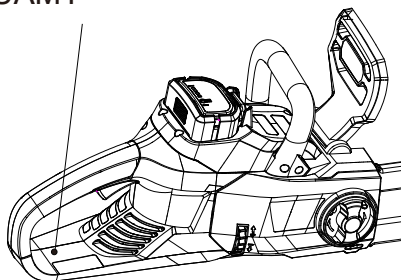

Battery Pack Serial Number
DAAAY-*****

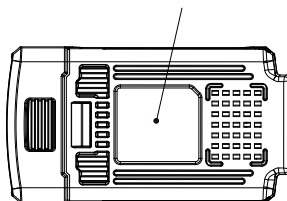

Manufacture:

Honda Power Products (Fuzhou) Co., Ltd

Address:

No.7 Houyu Road, Jin'an District, Fuzhou City, Fujian Province, China.

© 2024 Honda Motor Co., Ltd.
Printed in China

42Y0KS00
00X42-Y0K-S000